

GOBI FORD BRONCO REAR LADDER FOR HARD TOP ONLY INSTALLATION INSTRUCTIONS

Guidelines:

When using Load Carriers and Accessories, the user must understand the precautions. The points listed below will assist you in using the rack /carrier system and will encourage safety.

- For quality fits and safety, use only the recommended rack or accessory. Do not assume an accessory will fit, always check with dealer when obtaining new accessories. Use only approved accessories on load carriers. Using other brands will void your warranty.
- Make sure all knobs, bolts, screws, straps, and locks are firmly attached, tightened and locked before every trip. Knobs, bolts, screws, straps, and locks must be periodically inspected for signs of wear, corrosion, and fatigue. Check your load at stops during the trip to insure continued fastening security.
- Check local and state laws governing projection of objects beyond the width of a vehicle. **Be aware of the width and height of your cargo since low clearance branches, bridges, and parking garages can affect the load** All cargo will affect the vehicle's driving behavior. Never drive with any lock, knob, or rack in an open or unlocked position. All long loads such as, but not limited to sailboards, surfboards, kayaks, canoes, and lumber must be tied down front and rear to the bumpers or tow hooks, of the vehicle.
- Remove your rack accessories when they are not in use, before entering car washes, prior to taking in your vehicle for service, and whenever clearance may be an issue.
- All locks must be turned and moved periodically to insure smooth operation. Use graphite or similar dry lubricant to help this. Locks are designed to deter vandalism and theft. Remove valuable gear if your vehicle is unattended for an extended period. Place at least one key in the glove compartment.
- For safety to your vehicle and rack system, obey all posted speed limits and traffic cautions. Adapt your speed to the conditions of the road and the load being carried.
- Do not use load carriers and accessories for purposes other than those for which they were designed. Do not exceed their carrying capacity.
- Consult with your dealer if you have any questions regarding the operations and limits of this product. Review all instructions carefully.

**CAUTION: USE ANTI-SEIZE LUBRICANT ON ALL SCREWS
PRIOR TO INSTALLATION**

GOBI FORD BRONCO REAR LADDER FOR HARD TOP ONLY

INSTALLATION INSTRUCTIONS

Included in kit

Letter	Description	Location	Quantity
A	FORD BRONCO REAR DOOR LADDER HARD TOP ONLY	Main box	1
B	HANGER PLATE	Strapped to Ladder	1
C	LOWER LADDER SUPPORT PLATE (IP)	Strapped to Ladder	1
D	GOBI LADDER MOUNTING HARDWARE CONTENTS: 4- 5/16-18 x 1" SS Button head screw 8- 5/16" SS Flat washer 4- 5/16" Nylock nut 1- 3/8-16 x 1-1/4" SS Hex head screw 2- 3/8" Flat washer 1- 3/8" Nylock nut 1- Brown adhesive backed wear pad 2- 1/2" x 3/4" x 4" Black foam gasket 2- 2" x 7" Clear wear strip tape	BAG #1 Hardware Box	1

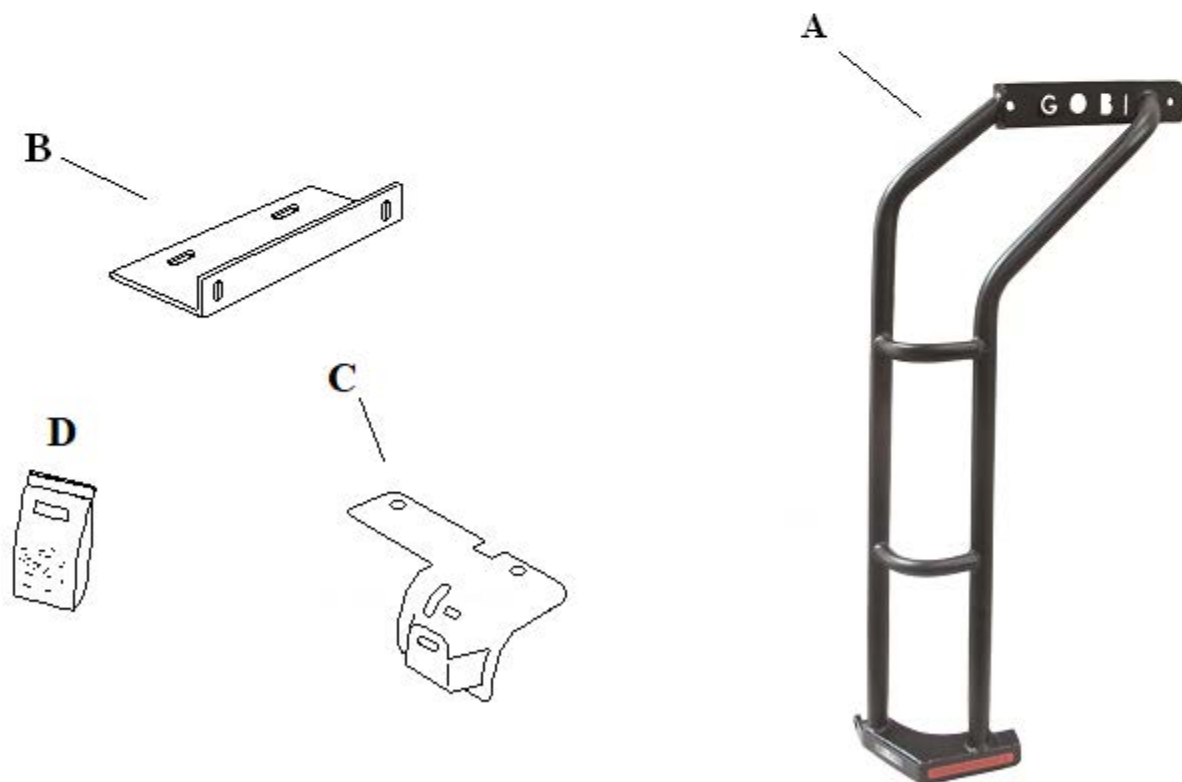

GOBI FORD BRONCO REAR LADDER FOR HARD TOP ONLY INSTALLATION INSTRUCTIONS

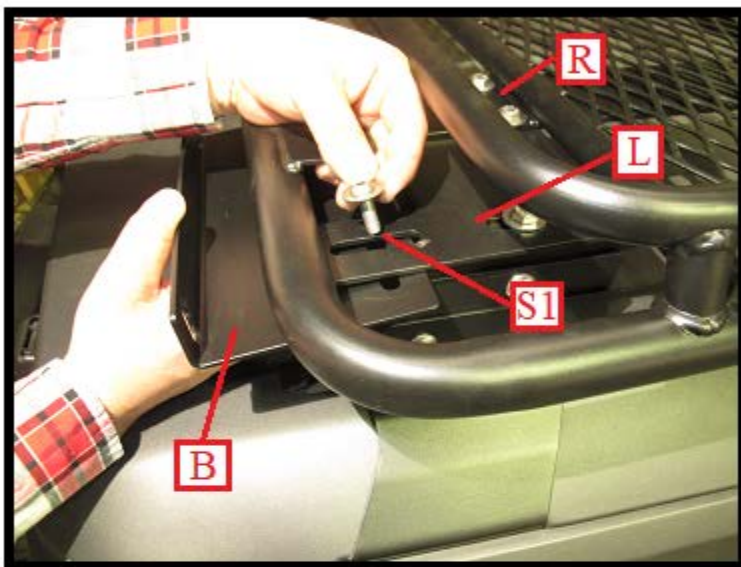
**Fig. 1**

As shown in Fig. 1 remove hanger plate (B) from your hardware kit and install on the passenger side rear corner of the roof rack. Place one 5/16-18 x 1" button head Allen screw and one 5/16" flat washer (S1) located in Bag #1, down through roof rack ladder support (R) and (L) then through hanger plate (B) as shown in Fig. 1. Thread onto each screw (S1) from the underside one 5/16" flat washer and one 5/16" nylock nut. Snug down in place using a 1/2" socket or box end wrench and one 3/16" Allen wrench located in Bag #1. Leave some play for adjustment.

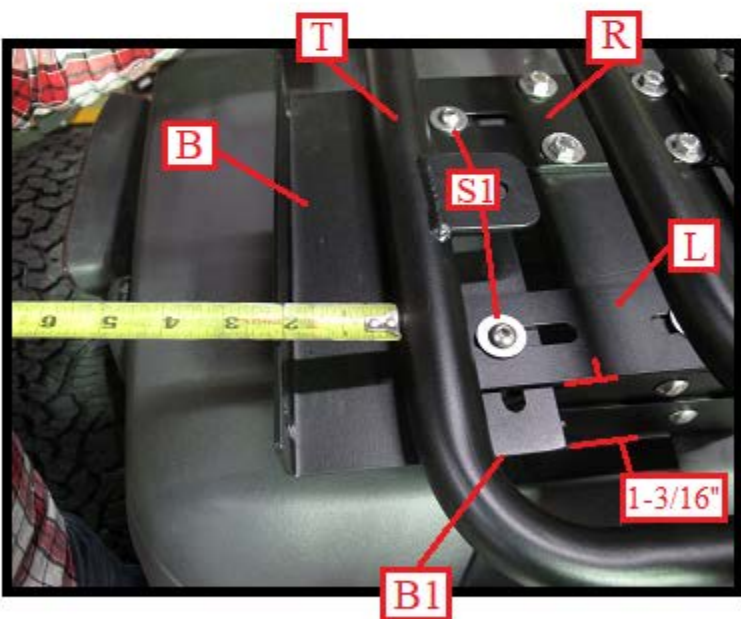
**Fig. 2**

Adjust hanger plate (B) in or out until you have a 2" gap between the inside of hanger plate (B) and the rear rack tube (T) as shown in Fig. 2. Follow by adjusting hanger plate (B) right or left until you have approximately 1-3/16" distance between the end of hanger plate edge (B1) shown in Fig. 2 to roof rack support (L). After these adjustments have been made, fully tighten down screws (S1) using a 1/2" ratchet or box end wrench and a 3/16" Allen wrench.

GOBI FORD BRONCO REAR LADDER FOR HARD TOP ONLY

INSTALLATION INSTRUCTIONS

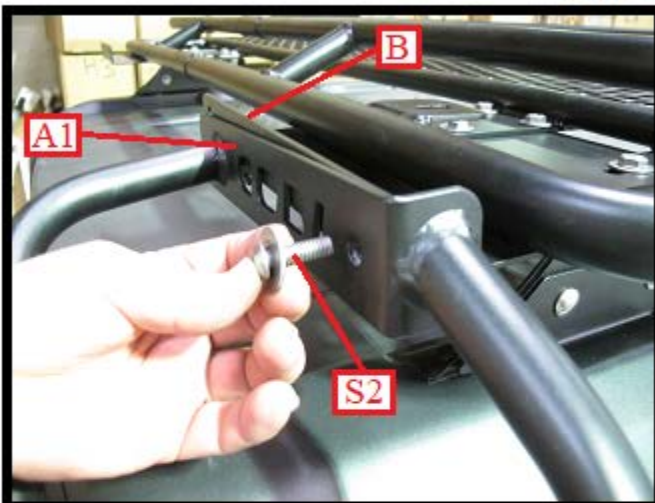
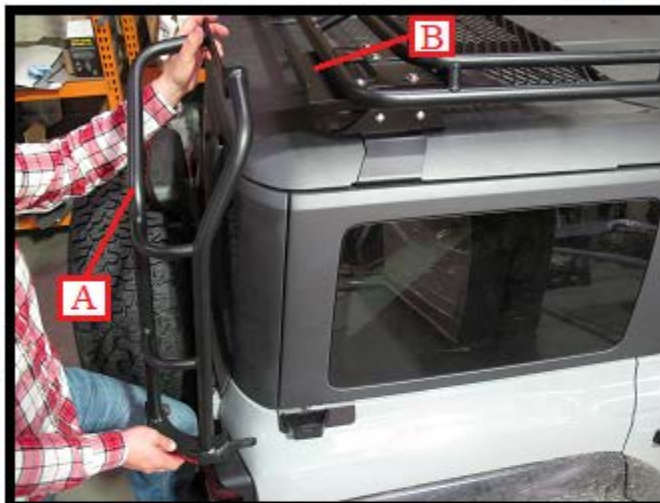
Fig. 3**Fig. 4**

As shown in Fig. 3 and Fig. 4, place passenger side ladder (A) onto hanger plate (B). Slide in one 5/16-18 x 1" button head screw and one 5/16" flat washer (S2) through upper ladder bracket (A1) and hanger plate (B). Then thread from the backside as shown in Fig. 5, one 5/16" flat washer and one 5/16" nylock nut (S2) and snug down place. Apply the same procedure to the other mounting hole, but do not fully tighten. Leave some play for adjustment.

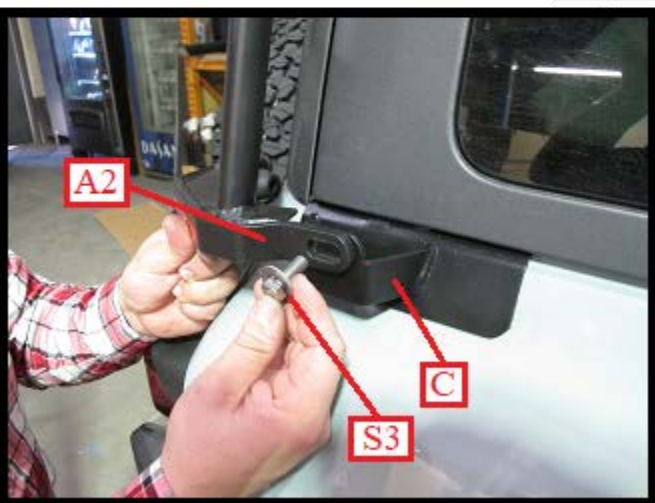
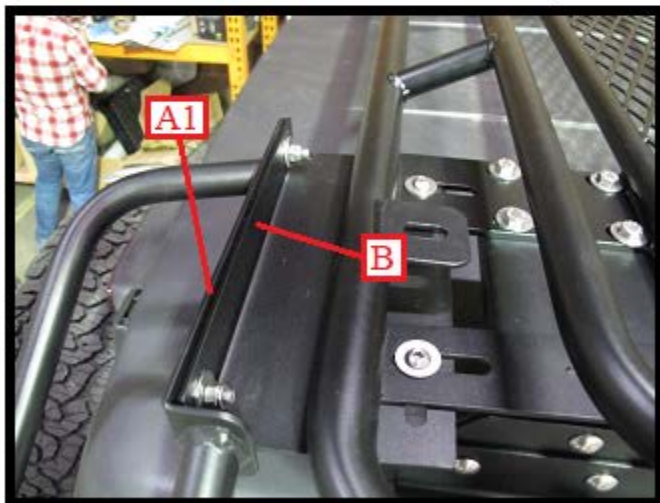
Fig. 5**Fig. 6**

As shown in Fig. 5, snug down the upper section (A1) of ladder (A) onto hanger plate (B), but leave some play for adjustment. Move down to the lower mounting point (A2) as shown in Fig. 6 and slide one 3/8-16 x 1-1/4" hex head screw and 3/8" flat washer (S3) in through lower ladder mount (A2) and lower ladder body mount (C). Thread from the back side one 3/8" flat washer and one 3/8" nylock nut. Do not fully tighten, leave some play for adjustment.

GOBI FORD BRONCO REAR LADDER FOR HARD TOP ONLY INSTALLATION INSTRUCTIONS

Fig. 9Fig. 10Fig. 11

Adjust ladder (A) up or down, left or right to align the top of the ladder with the roof rack as shown in Fig.9. Then fully tighten screws (S2) using a 1/2" box end wrench and one 3/16" Allen wrench. As shown in Fig. 10 and Fig. 11, adjust the bottom of ladder (A2) in or out so that you have approximately 1/4" or more between the body and ladder rubber bumper. Fully tighten screw (S3) using two 9/16" box end wrenches shown in Fig. 11.

Fig. 12

Open rear door and lift up the rear window slowly to make certain that the Gobi ladder clears window as shown in Fig. 12.

GOBI FORD BRONCO REAR LADDER FOR HARD TOP ONLY INSTALLATION INSTRUCTIONS



GOBI FORD BRONCO HARD TOP REAR LADDER INSTALLATION COMPETE