

GOBI JEEP KL REAR EXTERIOR MOLLE PANELS INSTALLATION INSTRUCTIONS

Guidelines:

When using Load Carriers and Accessories, the user must understand the precautions. The points listed below will assist you in using the rack /carrier system and will encourage safety.

- For quality fits and safty, use only the recommended rack or accessory. Do not assume an accessory will fit, always check with dealer when obtaining new accessories. Use only approved accessories on load carriers. Using other brands will void your warrenty.
- Make sure all knobs, bolts, screws, straps, and locks are firmly attached, tightened and locked before every trip. Knobs, bolts, screws, straps, and locks must be periodically inspected for signs of wear, corrosion, and fatigue. Check your load at stops during the trip to insure continued fastening security.
- Check local and state laws governing projection of objects beyound the width of a vehicle. **Be aware of the width and height of your cargo since low clearance branches, bridges, and parking garages can affect the load** All cargo will affect the vehicle's driving behavior. Never drive with any lock, know, or rack in an open or unlocked position. All long loads such as, but not limited to sailboards, surfboards, kayaks, canoes, and lumber must be tied down front and rear to the bumpers or tow hooks, of the vehicle.
- Remove your rack accessories when they are not in use, before intering car washes, prior to taking in your vehicle for service, and whenever clearance may be an issue.
- All locks must be turned and moved periodically to insure smooth operation. Use graphite or similar dry lubricant to help this. Locks are designed to deter vandalism and theft. Remove valuable gear if your vehicle is unattended for an extended period. Place at least one key in the glove compartment.
- For safety to your vehicle and rack system, obey all posted speed limits and traffic cautions. Adapt your speed to the conditions of the road and the load being carried.
- Do not use load carriers and accessories for purposes other than those for which they were designed. Do not exceed their carrying capacity.
- Consult with your dealer if you have any questions regarding the operations and limits of this product. Review all instructions carefully.

**CAUTION: USE ANTI-SEIZE LUBRICANT ON ALL
MOUNTING SCREWS**

GOBI JEEP KL REAR EXTERIOR MOLLE PANELS INSTALLATION INSTRUCTIONS

Included in kit

Letter	Description	Location	Quantity
A	GOBI JEEP KL REAR EXTERIOR MOLLE PANEL	Main Box	1
B	GOBI MOLLE PANEL ROOF RACK SUPPORT BRACKET	Main Box	1
C / C1	GOBI MOLLE PANEL HANGER PLATES PASSENGER OR DRIVER	Bag #2	1 ea.
D	GOBI MOLLE PANEL SUCTION CUPS	Main Box	2
E	MOLLE PANEL MOUNTING HARDWARE <u>CONTENTS:</u> 1- 3/8-16 x 1-1/4" Hex head screw 1- 3/8-16 x 1" Button head screw 2- 3/8" Flat washer 1- 3/8" Nylock nut 4- 1/4-20 x 3/4" Button head screws 8- 1/4" Flat washers 4- 1/4" Nylock nuts 1- Anti-seize lubricant	Bag #3	1

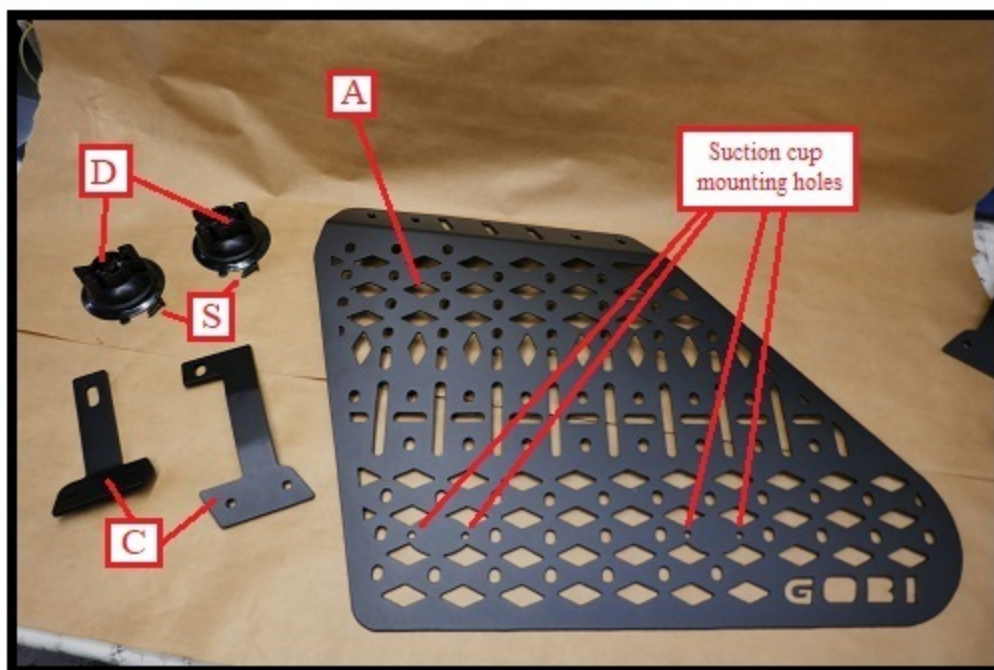

GOBI JEEP KL REAR EXTERIOR MOLLE PANELS INSTALLATION INSTRUCTIONS

**Fig. 1**

As shown in Fig. 1, place the Gobi exterior cargo panel (A) passenger or driver side on a flat surface with the GOBI logo faced up. Then remove one supplied suction cup (D) from your hardware kit and install as shown under the cargo panel in Fig. 2. Use two black screws (S) supplied with suction cup and thread each screw through suction cup mounting holes shown in Fig. 1 and into suction cup (D).

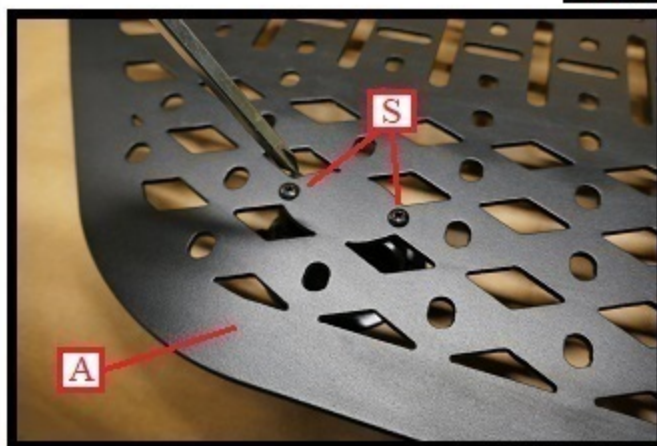
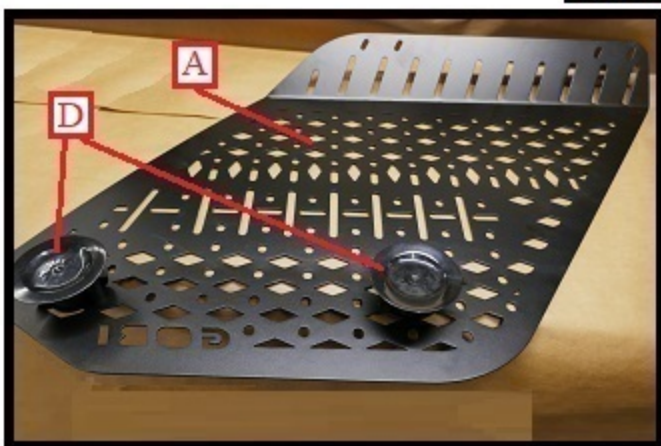
Fig. 2**Fig. 3**

As shown in Fig. 2, use a Phillips screwdriver and fully tighten both screws (S) in place. Install the second suction cup in the same manner shown in Fig. 3.

GOBI JEEP KL REAR EXTERIOR MOLLE PANELS INSTALLATION INSTRUCTIONS

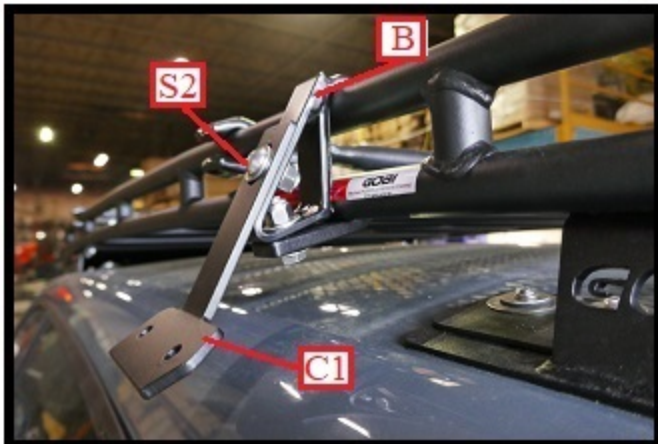
Fig. 4**Fig. 5**

As shown in Fig. 4, remove support bracket (B) from your hardware kit and install onto the top roof rack rail approximately 13" from the driver side end of the roof rack. Fully tighten clamp (B) in place using two 9/16" open or closed end wrenches. As shown in Fig. 5, remove the left side support bracket (C1) from your hardware kit and install as shown using one 3/8-18 x 1" button head screw and 3/8" washer (S2) from Bag #3 of your hardware kit. Secure in place from the underside with one 3/8" flat washer and 3/8" nylock nut also located in Bag #3.

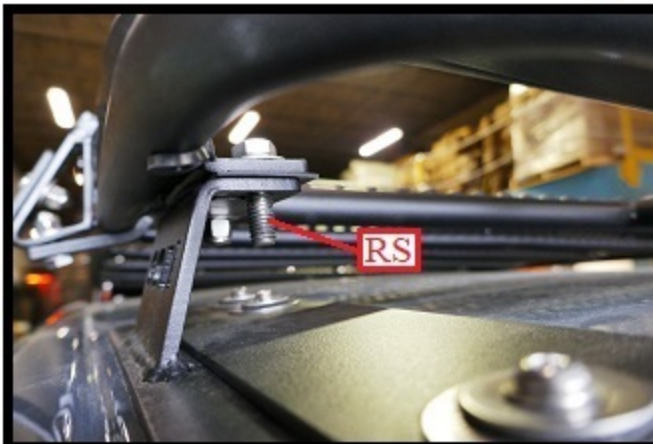
Fig. 6**Fig. 7**

As shown in Fig. 6, replace the rear roof rack support bracket screw with a longer 3/8-16 x 1-1/4" hex head screw (RS) supplied in Bag #3 of your hardware kit. Then as shown in Fig. 7, install molle panel hanger plate (C) under rear rack support and onto screw (RS) and secure in place with one 3/8" flat washer and nylock nut. Snug screw down but do not fully tighten. Both hanger plates (C1) and (C) must have a little play for later adjustment. Before continuing onto the next step, clean the rear window off with window cleaner.

GOBI JEEP KL REAR EXTERIOR MOLLE PANELS INSTALLATION INSTRUCTIONS

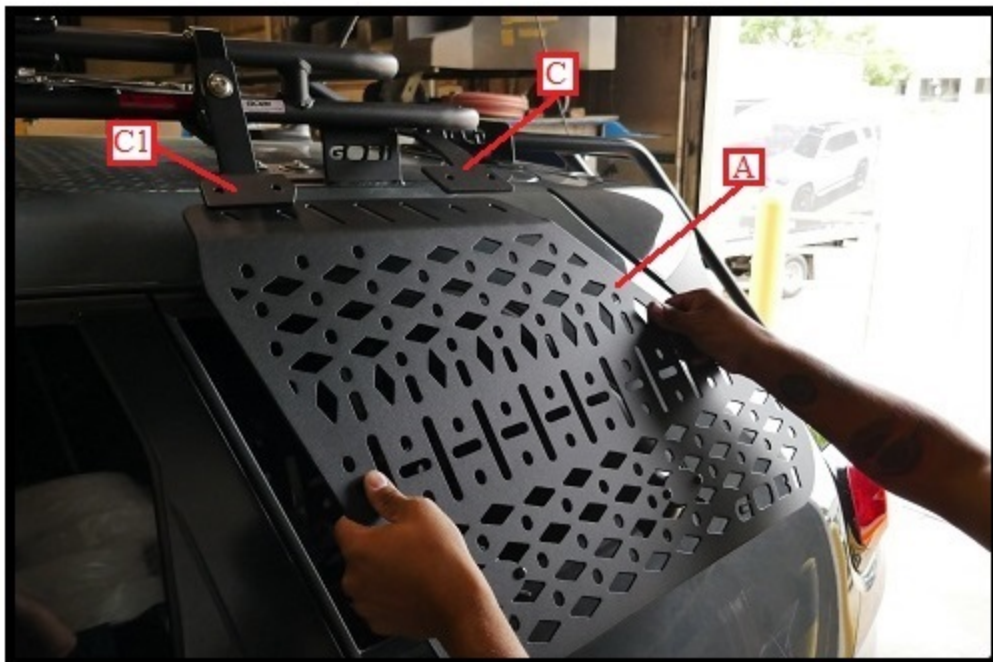
**Fig. 8**

As shown in Fig. 8, with the help of a friend. Set the driver side molle panel (A) under both hanger plates (C1) and (C). Try not to lay suction cups on window at this time as the molle panel will be difficult to adjust. If the suction cup or cups should attach to the window, use your fingertip to lift one edge of the suction cup to release.

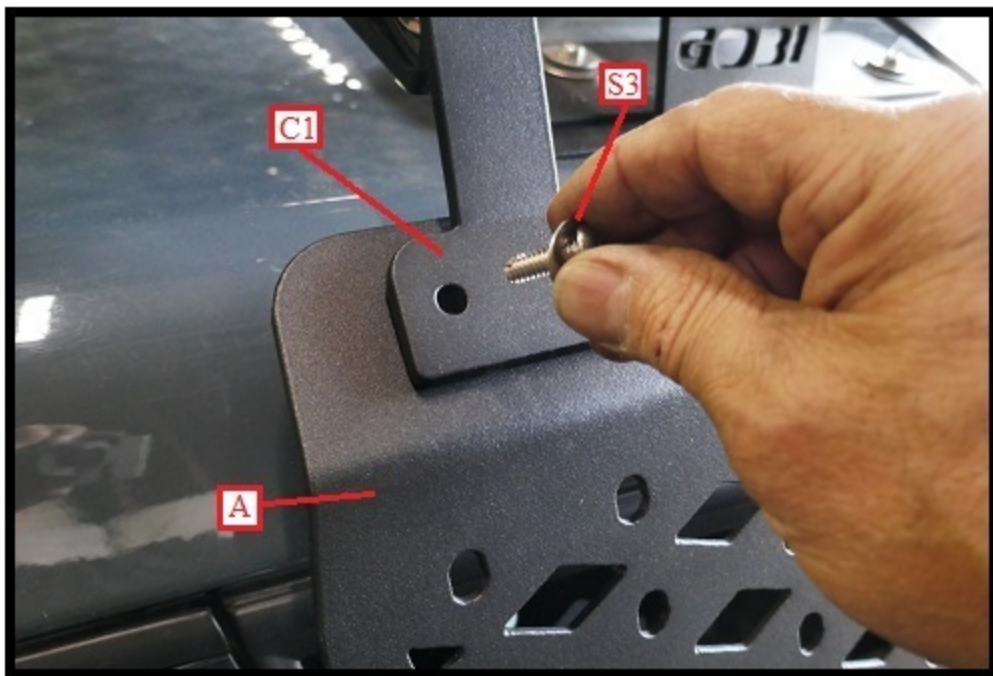
**Fig. 9**

As shown in Fig. 9, remove from hardware Bag #3 one 1/4-20 x 3/4" button head and flat washer (S3). Make certain to use anti-seize on all screws prior to assembly. Insert the screw and washer into the hole of hanger plate (C1) then into molle panel mounting hole. Secure in place with one 1/4" flat washer and one 1/4-20 nylock nut from the backside. Snug down in place do not fully tighten down at this time.

GOBI JEEP KL REAR EXTERIOR MOLLE PANELS INSTALLATION INSTRUCTIONS

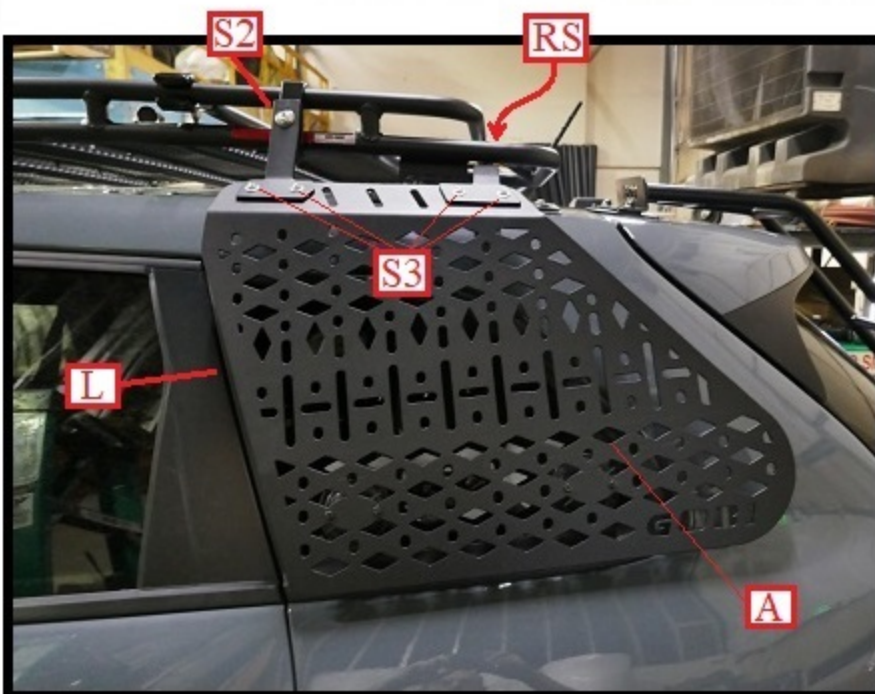
**Fig. 10**

As shown in Fig. 10, position cargo panel (A) so that the left-hand side (L) is in line with rear window. Also check that the rear door when opened is approximately 1/2" away from Molle panel edge (L) then set suction cups down onto rear window. This adjustment may need to be made a couple of times before you are satisfied with alignment. Once cargo panel is set fully tighten screw (S2) shown in Fig. 5 using a 7/32" Allen wrench and a 9/16" open end wrench. Then tighten screw (RS) in Fig. 7 using two 9/16" open end wrenches. Fully tighten all four screws (S3) using a 5/32 Allen wrench and 3/8" box end wrench.

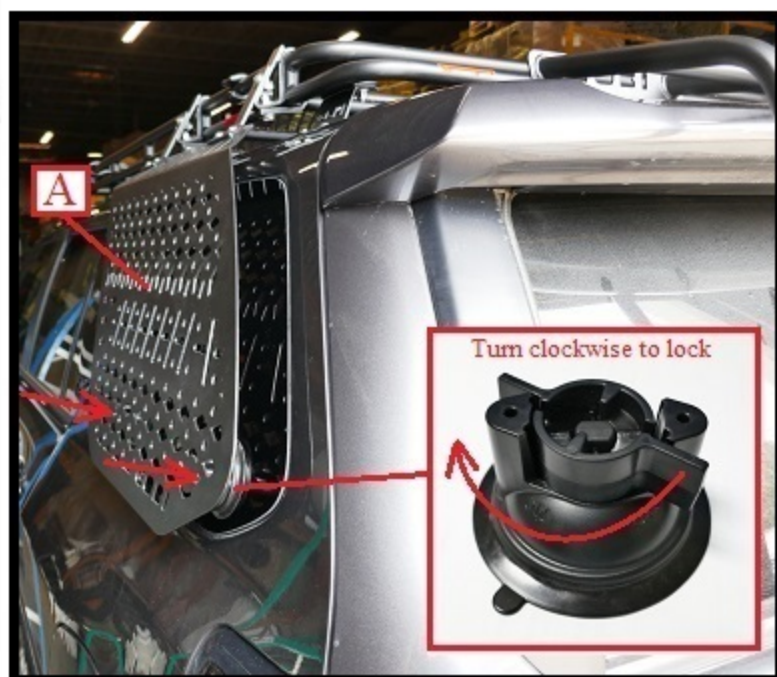
**Fig. 11**

As shown in Fig. 11, after all screws are fully tightened, press down firmly as shown by red arrows and turn the locking wing on the suction cup clockwise to seal the cup onto the window. Apply the same to the other suction cup.

GOBI JEEP KL REAR EXTERIOR MOLLE PANELS INSTALLATION INSTRUCTIONS

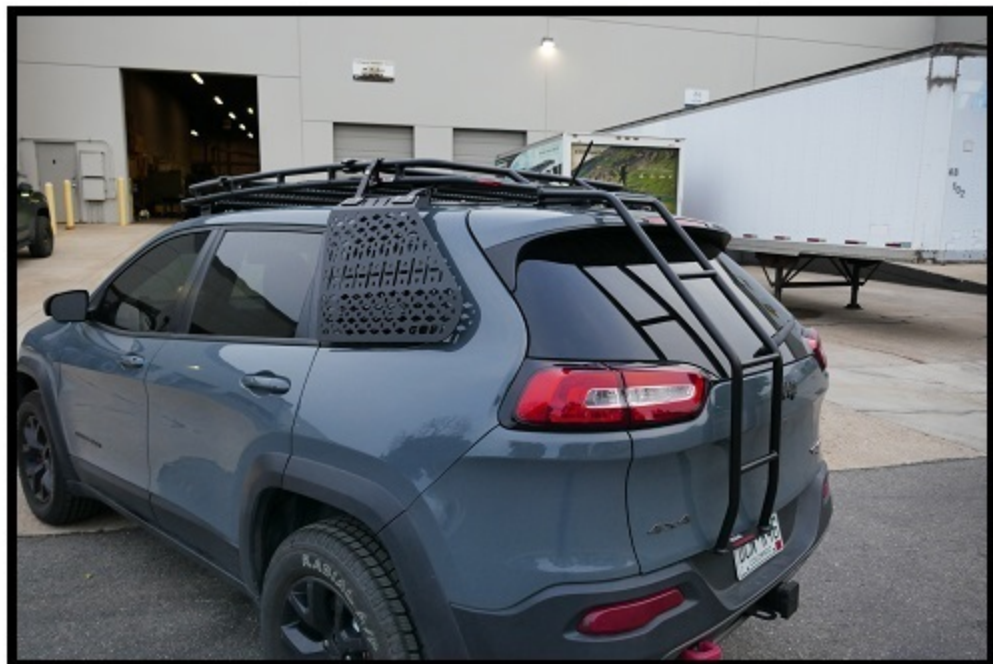

INSTALLATION COMPLETED