

GOBI STEALTH JK/JL/BRONCO BAJA DESIGNS 8XL LINKABLE LED SUPPORT BRACKETS INSTALLATION INSTRUCTIONS

Included in kit

Letter	Description	Location	Quantity
A	GOBI STEALTH BAJA 8XL LINKABLE LED SUPPORT BRACKETS	Main box	2
B	GOBI BAJA DESIGNS 8XL CENTER SUPPORT BRACKET COMPLETE	Main box	1
C	<p style="text-align: center;">BRACKET HARDWARE</p> <p><u>CONTENTS:</u> 2- 3/8 x 1" SS Carriage bolts 2- 3/8" SS Flat washer 2- 3/8" SS Nylock nut 2- 1/4" x 1" SS Button head allen screw 4 1/4" Black nylon washers 2- 1/4" SS Nylock nuts 2- 1" Steel vinyl coated straps 2- 1/4-20 x 1" SS Button head screws 2- 1/4" SS Nylock nuts 4 1/4" Black Nylon washers 1- 1/4-20 X 1" SS hex head screw 2- 1/4" SS flat washers 1- 1/4" SS nylock nut 1- Pack of Anti-Seize Lubricant</p> <div style="display: flex; justify-content: space-between; margin-top: 10px;"> <div style="border: 1px solid red; padding: 2px; font-size: small;">Wind Deflector extension hardware</div> <div style="border: 1px solid red; padding: 2px; font-size: small;">Vinyl clamp hardware</div> <div style="border: 1px solid red; padding: 2px; font-size: small;">Gobi KC center support bracket</div> </div>	BAG #1	1

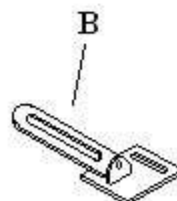
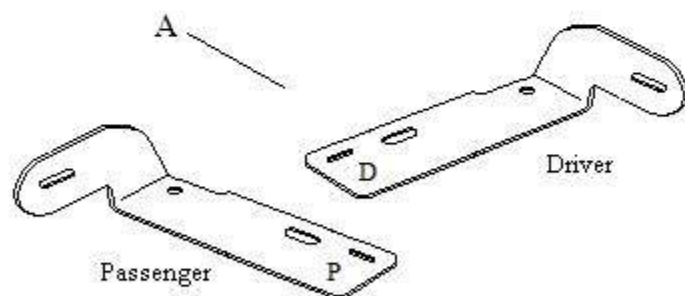

BAG #1

CAUTION: USE ANTI-SEIZE LUBRICANT ON ALL SCREWS

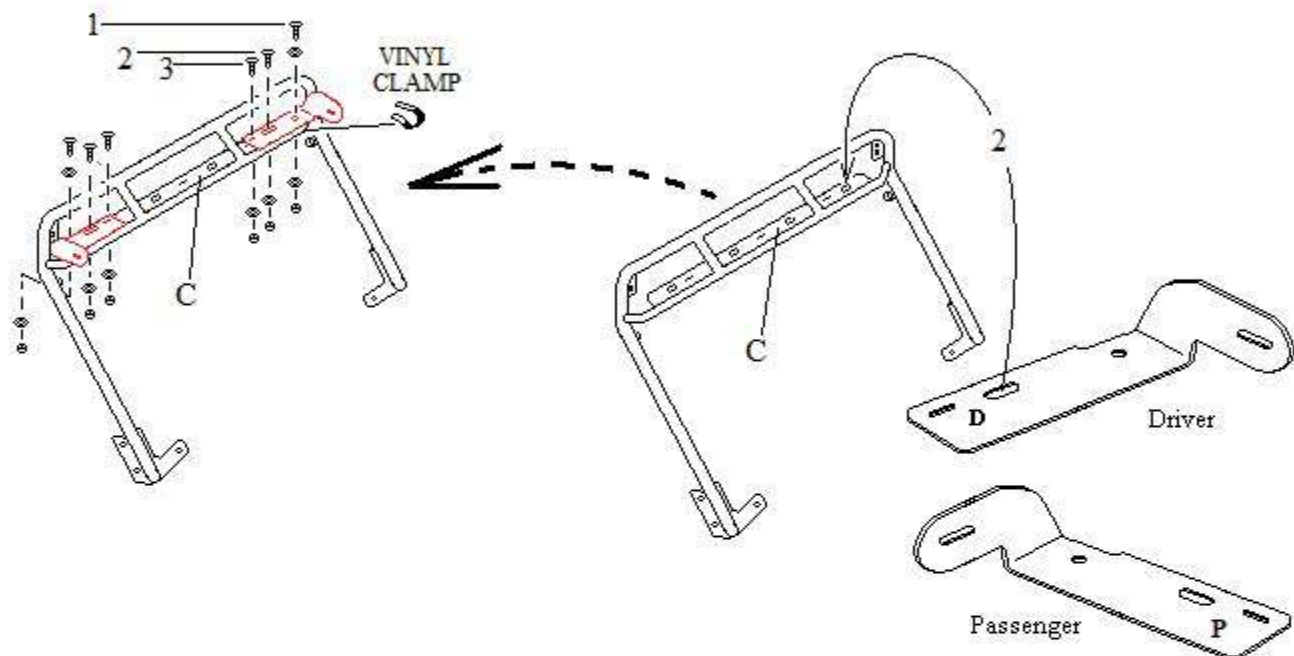
GOBI STEALTH JK/JL/BRONCO BAJA DESIGNS 8XL LINKABLE LED SUPPORT BRACKETS INSTALLATION INSTRUCTIONS

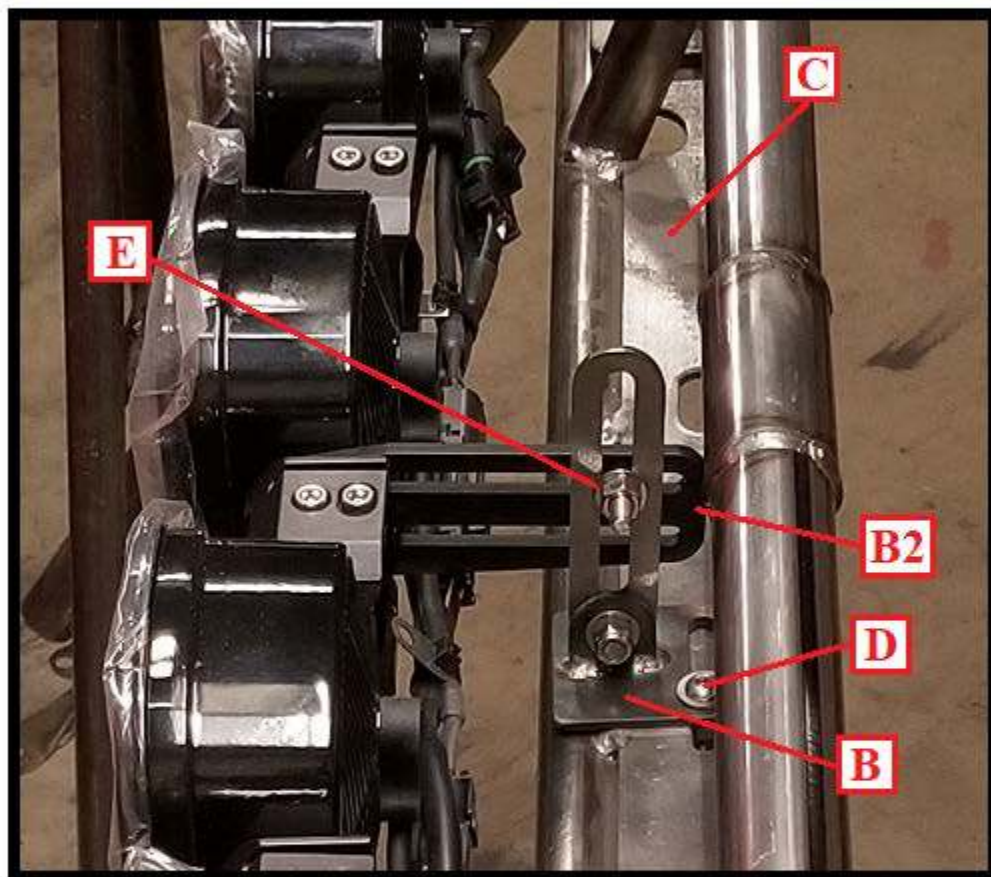

- A) Mount driver side Gobi LED bracket as shown above using one 3/8-16 x 1" carriage screw, 3/8" flat washer and 3/8" nylock nut, in slot #2 of LED bracket towards the end of light bar mounting plate (C). Apply the same procedure to the opposite side and snug down only at this time.
- B) Slide a vinyl clamp as shown above under LED bracket and around tube and mount in place using the supplied 1/4-20 x 1" button head screw, black nylon flat washer and nylock nut in hole #1 of bracket. Snug down only, allow for adjustment. Apply the same procedure to the opposite side and snug down only at this time.
- C) Mount LED light bar between brackets and snug down with LED hardware.
- D) Install the Gobi wind deflector if available as shown in the original Gobi roof rack installation instruction guide. Use the longer 1/4-20 x 1" button head screws supplied in your hardware kit for slot #3, the wind deflector slot. Center wind deflector and LED and tighten all screws.

**GOBI STEALTH JK/JL/BRONCO BAJA DESIGNS
8XL LINKABLE LED SUPPORT BRACKETS
INSTALLATION INSTRUCTIONS****Fig. 1**

As shown in Fig. 1 above, attach the Gobi center support bracket (B) to the center slot of the light bar mount plate (C). Use the supplied 1/4-20 x 1" hex head screw, two 1/4" flat washers and one 1/4" nylock nut (D) to secure the center support bracket in place. Snug down only at this time. Attached LED center support (B2) to the Gobi center support bracket (B) using the LED light bracket screw (E). Snug down only at this time. Adjust the angle of the LED light then fully tighten all screws.

INSTALLATION COMPELTED