

## GOBI FULL SIZE HUMMER H3 ROOF RACK INSTALLATION INSTRUCTIONS

### Guidelines:

When using Load Carriers and Accessories, the user must understand the precautions. The points listed below will assist you in using the rack /carrier system and will encourage safety.

- For quality fits and safty, use only the recommended rack or accessory. Do not assume an accessory will fit, always check with dealer when obtaining new accessories. Use only approved accessories on load carriers. Using other brands will void your warrenty.
- Make sure all knobs, bolts, screws, straps, and locks are firmly attached, tightened and locked before every trip. Knobs, bolts, screws, straps, and locks must be periodically inspected for signs of wear, corrosion, and fatigue. Check your load at stops during the trip to insure continued fastening security.
- Check local and state laws governing projection of objects beyound the width of a vehicle. **Be aware of the width and height of your cargo since low clearance branches, bridges, and parking garages can affect the load** All cargo will affect the vehicle's driving behavior. Never drive with any lock, know, or rack in an open or unlocked position. All long loads such as, but not limited to sailboards, surfboards, kayaks, canoes, and lumber must be tied down front and rear to the bumpers or tow hooks, of the vehicle.
- Remove your rack accessories when they are not in use, before intering car washes, prior to taking in your vehicle for service, and whenever clearance may be an issue.
- All locks must be turned and moved periodically to insure smooth operation. Use graphite or similar dry lubricant to help this. Locks are designed to deter vandalism and theft. Remove valuable gear if your vehicle is unattended for an extended period. Place at least one key in the glove compartment.
- For safety to your vehicle and rack system, obey all posted speed limits and traffic cautions. Adapt your speed to the conditions of the road and the load being carried.
- Do not use load carriers and accessories for purposes other than those for which they were designed. Do not exceed their carrying capacity.
- Consult with your dealer if you have any questions regarding the operations and limits of this product. Review all instructions carefully.

## GOBI FULL SIZE HUMMER H3 ROOF RACK INSTALLATION INSTRUCTIONS

### Included in kit

Letter	Description	Location	Quantity
A	GOBI HUMMER H3 FULL SIZE ROOF RACK	Main box	1
B	FAIRING RUBBER PROTECTIVE STRIP	pre-assembled	1
C-1 or C-2	FAIRING C-1 Standard or C-2 Marker Light Bar Style (Determined upon initial order)	banded to rack	1
D	FAIRING BRACKETS (pre-assembled to fairing)	pre-assembled	4
E	FAIRING BRACKET HARDWARE CONTENTS: 3- 1/4-20x3/4" SS Button head screw 6- 1/4" Black nylon washer 3- 1/4-20 Nylok nut	<b>BAG #2</b> Hardware Box	1
F	GOBI SUPPORT BRACKETS	Hardware Box	8
G	GOBI SUPPORT BRACKET HARDWARE CONTENTS: 6- "T" nut Aluminum 12- 5/16"-18 x 1" Stainless button head screw 12- 5/16" Stainless washer 12- 5/16" Stainless lock washer 6- Black rubber pads 1- 3/16" allen wrench 2- 6mm x 60mm support bracket screws 2- 6mm washers 2- Lock washers 2- Plastic spacers 1- T-27 Torx drive wrench 1- 4mm allen wrench 1- Packet Anti-seize lubricant  Inside Bag #3	<b>BAG #3</b> Hardware Box	1
H	GOBI SUPPORT BRACKET HARDWARE CONTENTS: 16- 3/8 -16 x 1" SS Hex bolt 32- 3/8" SS Flat washers 16- 3/8" Nylock nuts 8- Black rubber pads	<b>BAG #4</b> Hardware Box	1
I	GOBI DRIVING/FOG LIGHT SPACER WASHER CONTENTS: 28- washer black zinc (not required for Stealth roof rack)	<b>BAG #5</b> Driving/Fog Light Spacer Washers	1

## GOBI FULL SIZE HUMMER H3 ROOF RACK INSTALLATION INSTRUCTIONS

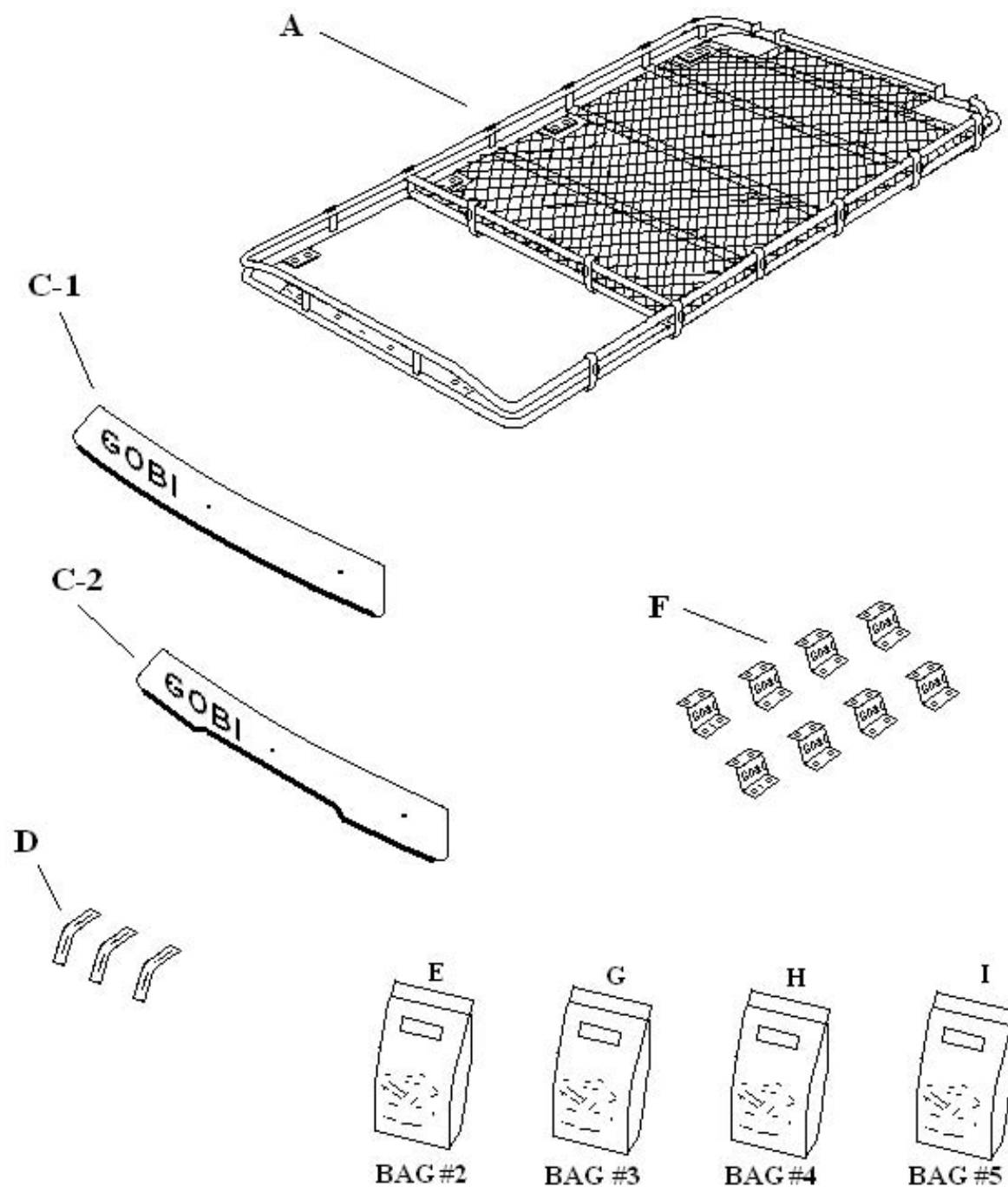

## GOBI FULL SIZE HUMMER H3 ROOF RACK INSTALLATION INSTRUCTIONS

The rack must be inspected before each use to make certain attachments are secure, and for evidence of Wear. Misuse of the rack or failure to observe the manufacturer's instructions as to installation, proper Attachment and maintenance will void any warranties that may be implied by law.

### Installation Instructions:

- 1- Using the hardware list on page 2 of the Gobi instructions manual check to verify that all hardware is present prior to install.
- 2- Remove factory OEM cross bars if present at this time they are no longer needed.
- 3- Refer to page 5 Fig. 2, 3, 4 and 5 then remove black "T" nuts located in plastic bag #3 included in your hardware kit. Install all 6 "T" nuts by slipping the "T" nuts into the roof top OEM track as shown and dimensioned in Fig. 2, 3, and 5 on page 5. Place on top of OEM factory roof track above each "T" nut rubber pads #7 as shown in Fig. 5. Using the 5/16" button head screws, washer and lock washer located in bag #3 place all 6 Gobi support brackets with the label "THIS SIDE UP" facing upwards onto the rubber pads #7 above each "T" nut and thread screws into each "T" nut as shown in Fig. 4, 5 and 1. Snug down screws only at this time.
- 4- Refer to page 6 and remove OEM screws #8c from vehicle roof trim using the T-27 Torx wrench located in bag 3. Install plastic spacer #8b located in bag #3 into the H3 roof trim well Fig. 7 page 6 and place the Gobi support bracket #8a labeled "FRONT" over the spacer as shown. Continue by using the 4mm Allen wrench located in bag #3 and place the 6mm x 60mm metric screw and washer through the center slot of the Gobi support bracket #8a and down through the plastic spacer #8b then into vehicle roof and snug down as shown in Fig. 6 page 6. Do not fully tighten at this time.
- 5- Refer to page 5 Fig. 4 and place the Gobi roof rack #11 onto the 8 installed Gobi brackets #8. Take "CAUTION" while lifting the Gobi rack onto the vehicle roof top so as not to damage the XM/On Star antenna. Align bolt holes of welded in flanges #11a of roof rack #11 Fig. 4 to Gobi support bracket bolt holes #8 then slide in between the support brackets #8 and roof rack welded in flanges #11a rubber pad #7 Fig. 5 and 4. Remove the 3/8"-16 x 1" bolts, washers and nuts #12 Fig. 4 from plastic bag #4 included in your hardware kit and attach roof rack #11 to support brackets #8 as shown in Fig. 4. Finger tighten only at this time.
- 6- Refer to page 3, farring installation is determined by the vehicle roof trim. The C-1 farring shown on page 3 is designed to fit a roof line with No exterior front Marker lights. The C-2 farring also shown on page 3 is designed for a roof line with a "Marker Light Bar" trim. Referring to page 7 Fig. 8 position the farring so that the center farring bracket #4 is on the center of the light bar farring slot #5a. If you are attaching a C-2 farring make sure that the farring is positioned behind the Marker lights as shown in Fig. 9 page 7. Remove the screws, nuts, lock washers and black plastic washers from bag #2 included in your hardware kit then begin by attaching the center farring bracket #4 to the light bar center slot #5a Fig. 8. Leave approximately 1" to 2" gap between the farring and the roof rack tubing as shown in Fig. 9 a page 7. Once the center is attached snug down only to prevent slippage at this time. Pull the outsides of the farring close to the roof rack causing a bow to form in the farring then place the screws and nuts in place and tighten down. Apply the same procedure to the opposite side. Make certain that the farring rubber strip is in full contact with either the roof top or "Marker Light Bar" if present throughout the farring length, then tighten completely. Installation is now complete.

## GOBI FULL SIZE HUMMER H3 ROOF RACK INSTALLATION INSTRUCTIONS

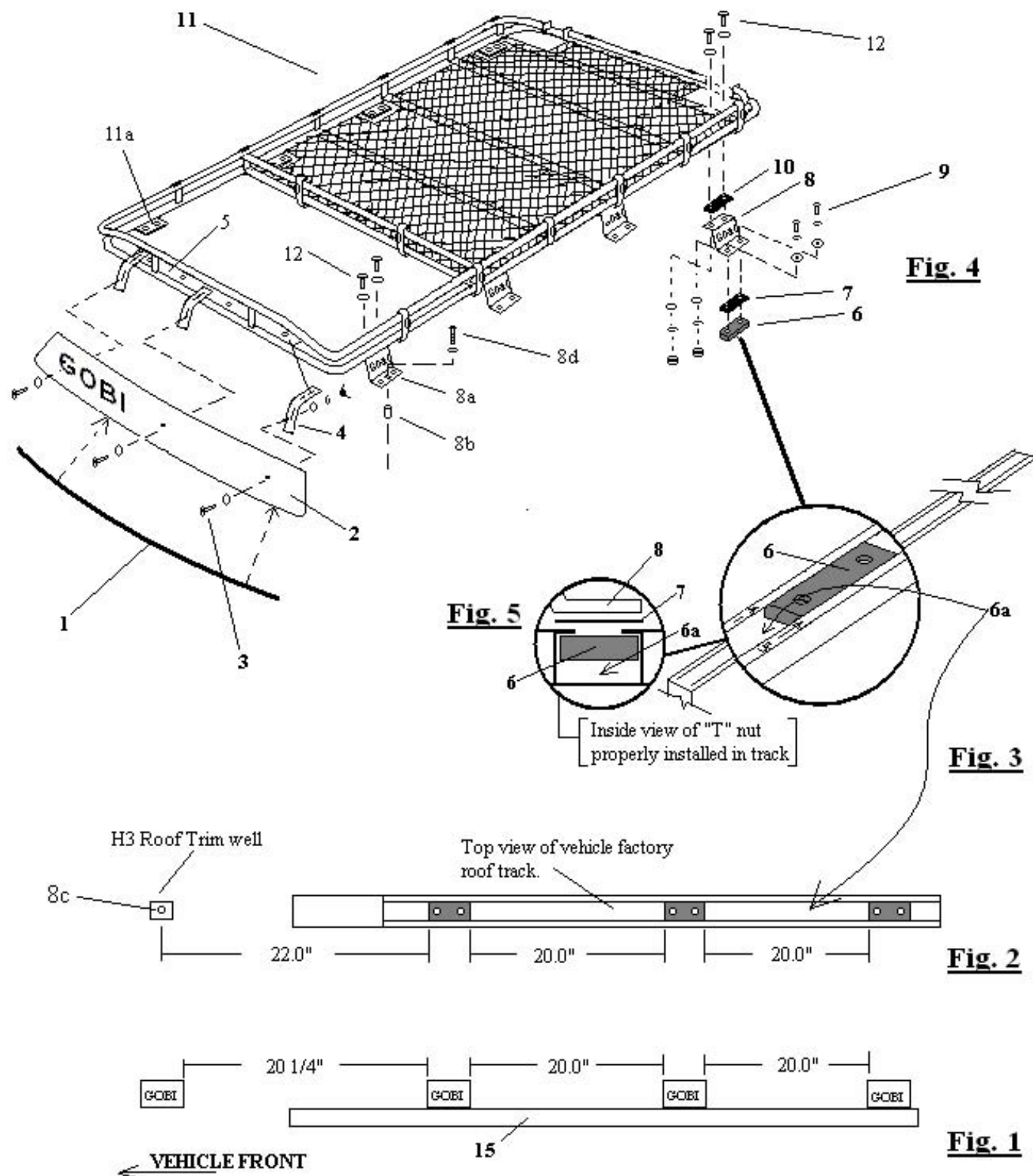

## GOBI FULL SIZE HUMMER H3 ROOF RACK INSTALLATION INSTRUCTIONS

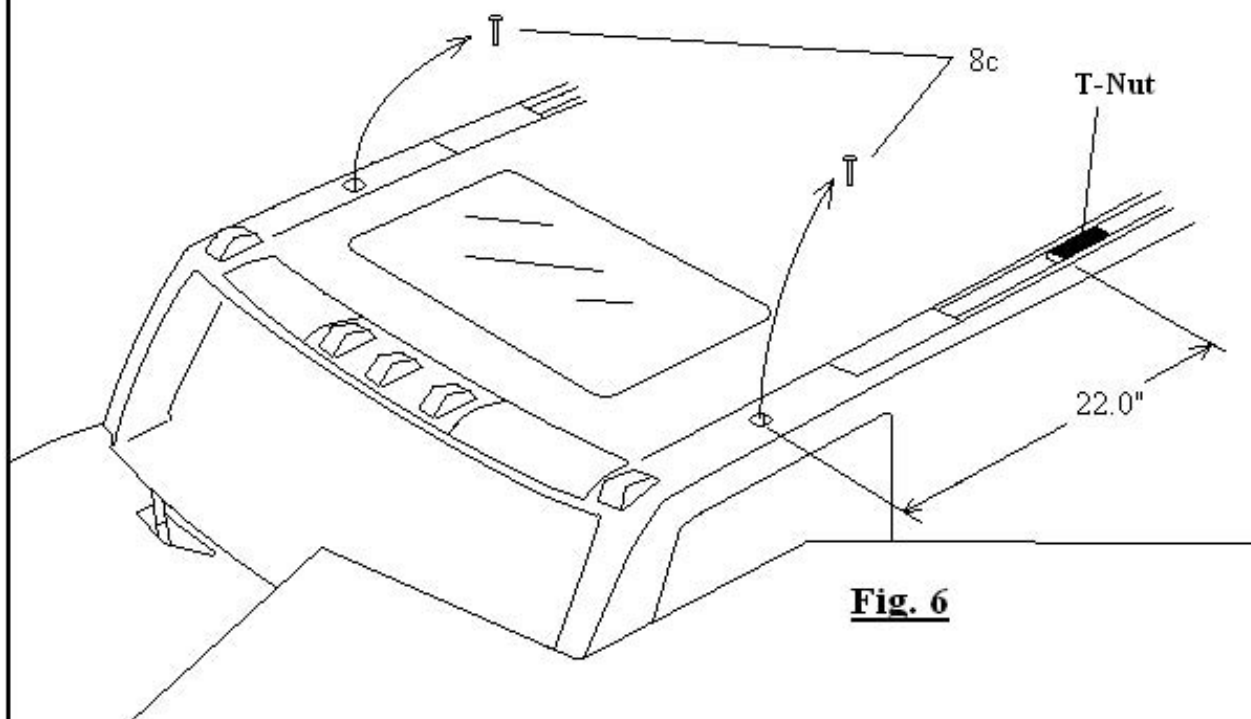
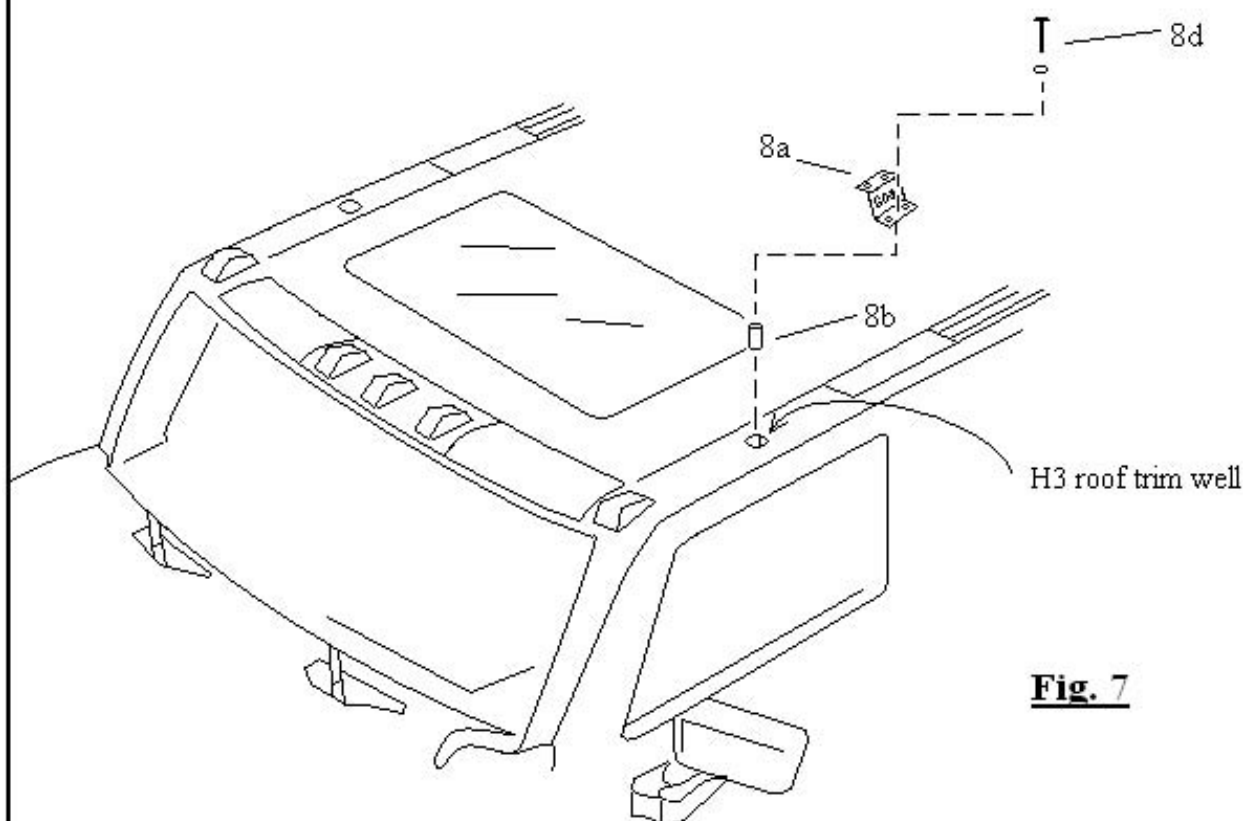
**Fig. 6****Fig. 7**

## GOBI FULL SIZE HUMMER H3 ROOF RACK INSTALLATION INSTRUCTIONS

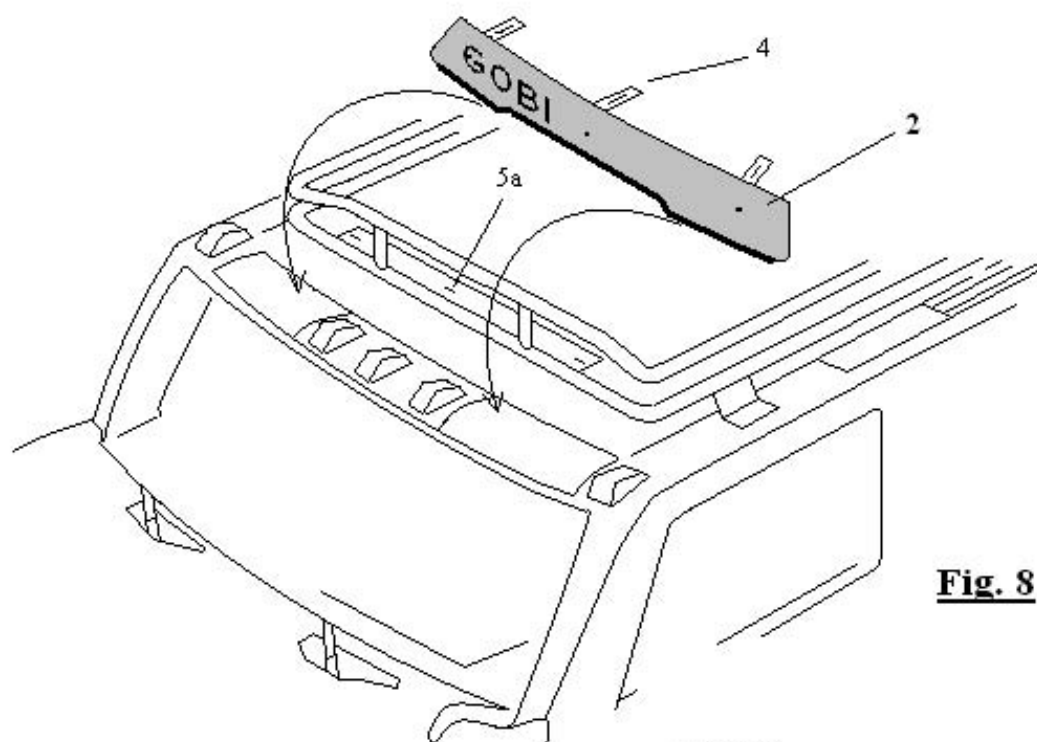
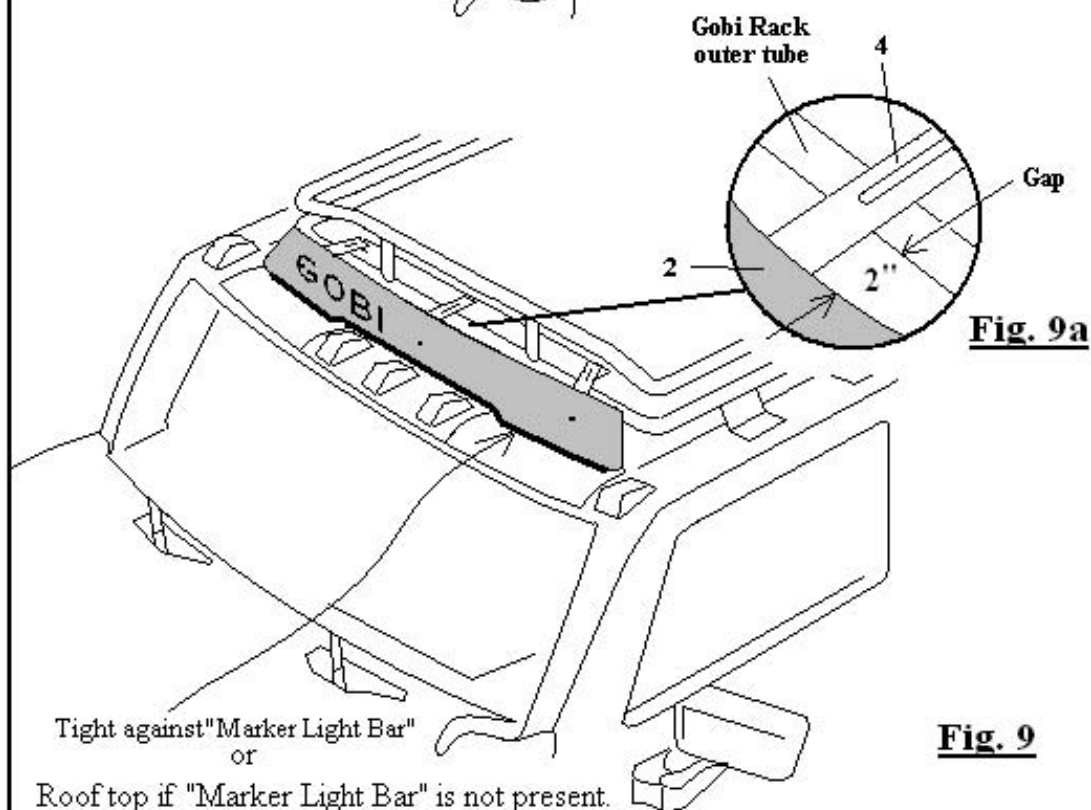
**Fig. 8****Fig. 9a****Fig. 9**

# INTELLIGENT DESIGNS 2000 CORPORATION

This limited one year warranty covers ONLY Intelligent Designs 2000, Corporation ("ID2000") products. Please review the terms and conditions of the limited warranties below.

## LIMITED ONE YEAR WARRANTY

**All warranties and representations, except as set out below, are hereby disclaimed, (including fitness for the purchaser's intended use or purpose and merchantability), all products being sold AS IS, without warranty beyond that made herein, with the purchaser assuming: 1) the entire risk as to the quality and performance of the goods, 2) the cost of any repairs not covered herein.**

Intelligent Designs 2000 Corporation warrants, as limited herein, to the original purchaser that its product which have been properly installed per provided instructions are free from defects in material and/or workmanship. At Intelligent Designs 2000 option, the purchaser's remedy hereunder shall be limited to repair or replacement of defective parts returned to the place of purchase or to Intelligent Designs 2000 at the purchaser's expense.

Intelligent Designs 2000 warranty, as herein, shall only be effective while the original purchaser owns the vehicle on which the product or products was installed and shall not apply if the product has been removed from the original vehicle. Intelligent Designs 2000 warranty is void if any damage to the product or products is due to misuse, abuse, neglect, accident, improper installation, or contact with on-road or off-road hazards, product modification, improper or inadequate maintenance or any use contrary to the instructions accompanying the product. Intelligent Designs 2000 warranty only covers the cost of the defective part and not the cost of removal, installation, and painting or other incidental or consequential charges or damages, or personal injury damages, and does not cover use of any product on racing vehicles. Intelligent Designs 2000's warranty is not transferable from the original purchaser.

## THIS LIMITED WARRANTY DOES NOT APPLY TO:

1. Damages or problems that result from shipping, installation, maintenance, or separate system components.
2. Damages or problems that result from misuse, abuse, operation outside environmental specifications or contrary to the requirements or precautions in the Installation Instructions, accident, lightning strikes or other natural causes, unauthorized modification or alteration, incorrect electrical current or voltage, other causes not arising out of defect in material or workmanship.
3. Therefore, the cost of repair or replacement of such defective product shall be borne by the customer.

To assure product quality, Intelligent Designs 2000 reserves the right to change product designs, materials, specifications and finishes without prior notice to customers. Intelligent Designs 2000's warranty gives you specific legal rights and you may also have other rights, which vary from state to state. Some states do not limit on how long an implied warranty lasts, so the above limitations may not apply to you. Also, some states do not allow the exclusion or limitation of incidental or consequential damages so the above limitations or exclusions may not apply to you. Intelligent Designs 2000 reserves the right to discontinue product lines and substitute products or provide other remedies other than those listed in the limited warranty for those discontinued products.

THIS WARRANTY IS IN LIEU OF ANY OTHER WARRANTIES, EXPRESS OR IMPLIED, INCLUDING WITHOUT LIMITATION, ANY WARRANTY OF MERCHANT ABILITY OR FITNESS FOR A PARTICULAR PURPOSE. TO THE EXTENT ANY IMPLIED WARRANTY IS REQUIRED BY LAW, IT IS LIMITED IN DURATION TO THE EXPRESS WARRANTY PERIOD ABOVE. INTELLIGENT DESIGNS 2000 CORPORATION/ GOBI RACKS USA WILL NOT BE LIABLE FOR ANY CONSEQUENTIAL, INDIRECT, OR INCIDENTAL DAMAGES OF ANY KIND INCLUDING LOSS OF REVENUES OR PROFITS, IN CONNECTION WITH THE PRODUCT(S). SOME STATES DO NOT ALLOW LIMITATIONS ON HOW LONG AN IMPLIED WARRANTY LASTS OR THE EXCLUSION OF INCIDENTAL OR CONSEQUENTIAL DAMAGES, SO THE ABOVE LIMITATIONS OR EXCLUSIONS MAY NOT APPLY TO YOU.

## REQUESTING WARRANTY COVERAGE

For this warranty to be effective, it is strongly recommended that the purchaser completes and returns the warranty registration to Intelligent Designs 2000 within ten days of the date of purchase. Replacement parts can be obtained by returning the part along with proof of purchase. Warranty claims cannot be determined until the merchandise is received and inspected. **Returns made to Intelligent Designs 2000 will not be accepted without prior authorization from Intelligent Designs 2000. This included but is not limited to all shipping costs and all other incidental costs to be paid by the customer. Please call the customer service department at the number below.**

## LIMITED LIABILITY WARRANTY

Intelligent Designs 2000 Corporation warrants this product to be free of original defects in materials or workmanship as long as the original purchaser owns the motor vehicle on which it is installed. This warranty does not cover damage resulting from accident, misuse or abuse, neglect, lack or reasonable care, or improper installation. The Company will repair or replace, at its option, any product covered by this warranty that becomes defective. This is a parts-only warranty and such repair or replacement shall be the Company's sole obligation and the customer's sole remedy for a defective product. The Company shall have no liability for personal injury, property damage, incidental, or consequential damages of any kind or nature. THIS FOREGOING WARRANTIES ARE EXCLUSIVE AND IN LIEU OF ALL OTHER WARRANTIES, EXPRESS OR IMPLIED, AND THE COMPANY DISCLAIMS ALL OTHER WARRANTIES, EXPRESS OR IMPLIED, INCLUDING, WITHOUT LIMITATION, ANY IMPLIED WARRANTY OR MERCHANTABILITY OR FITNESS FOR A PARTICULAR PURPOSE.

To obtain warranty service, return this portion to Intelligent Designs 2000 Corporation with a proof of purchase to the address below. Please include;

First Name _____	Last Name _____
Address _____	City _____
E-mail _____	State _____
Phone Number _____	Zip Code _____